

CHAPTER 9

Installing Drives

This chapter explains how to remove and install hard-disk drives, diskette drives, and CD-ROM drives.

Hard-Disk Drives



CAUTION: Observe the precautions in “Safety First—For You and Your System” in Chapter 7 and the safety instructions in the *System Information* document that came with your system.

Figure 9-1 shows the locations of drives that can be installed in the system. Refer to this figure when you perform any of the procedures in the following subsections.

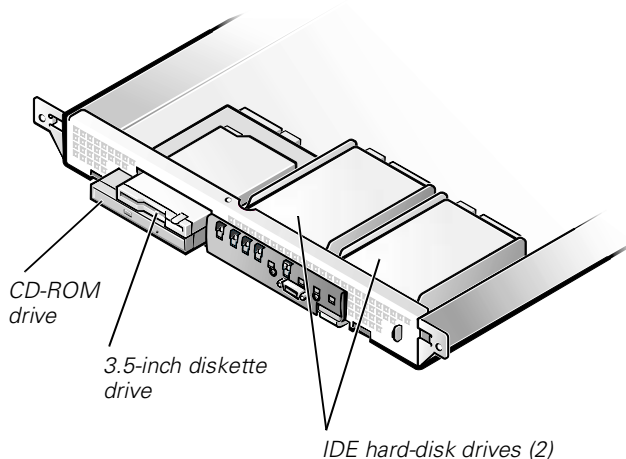

Figure 9-1. Drive Locations



NOTE: When you reinstall a replacement integrated drive electronics (IDE) hard-disk drive, ensure the drive has the identical part number and ensure any jumpers are at the settings you recorded.

Hard-Disk Drive Removal

Each hard-disk drive is mounted in a mounting bracket. The mounting bracket is secured to slots in the chassis front panel and to two snap-in posts at the back of the mounting bracket. To remove a faulty hard-disk drive and its mounting bracket, perform the following steps.



CAUTION: Observe the precautions in “Safety First—For You and Your System” in Chapter 7 and the safety instructions in the *System Information* document that came with your system.

NOTICE: See “Protecting Against Electrostatic Discharge” in the safety instructions in your *System Information* document.

1. Shut down the system and disconnect the cables.
2. Remove the bezel.
3. If you have not already done so, remove the system cover.
4. Remove the faulty hard-disk drive by lifting up at the rear of the mounting bracket, and then moving the hard-disk drive and bracket toward the back, still connected to its power and IDE interface cables (see Figure 9-2).
5. Disconnect the power and IDE interface connectors, and set the hard-disk drive and bracket on a nonconductive work surface.

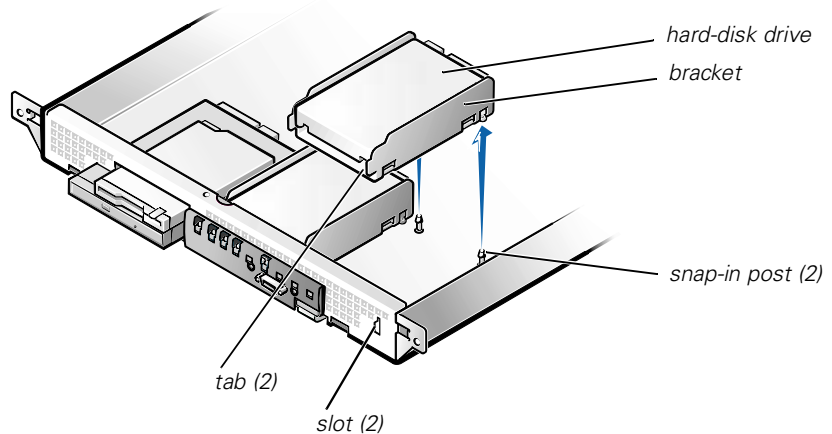

Figure 9-2. Hard-Disk Drive and Bracket Removal

6. Remove the four screws that secure the hard-disk drive to its bracket (see Figure 9-3).

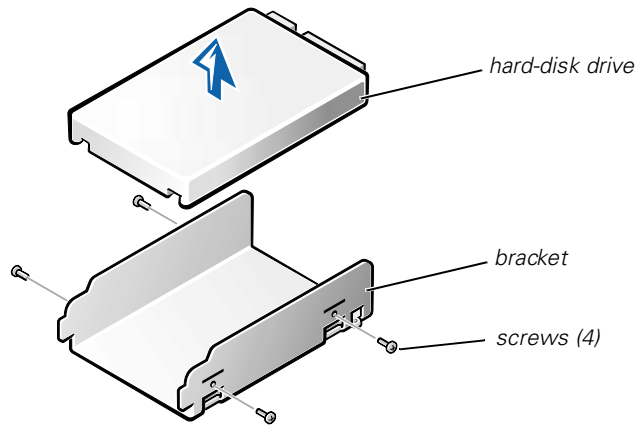

Figure 9-3. Hard-Disk Drive Removal From Bracket

Hard-Disk Drive Installation

To install the replacement hard-disk drive, perform the following steps:

1. Secure the replacement drive to the bracket using the four screws removed earlier (see Figure 9-3).
2. Install the power and IDE interface cable connectors to the back of the drive.
3. Insert the two vertical tabs on the front of the bracket into mating slots in the front panel of the chassis.
4. Press down at the rear of the drive until the bracket snaps into place on its snap-in posts.
5. Replace the system cover.
6. If you removed the front bezel in step 2 of "Hard-Disk Drive Removal," reinstall it now.
7. Run the Dell Diagnostics (see Chapter 5, "Running the Dell Diagnostics") to test and prepare the new drive.

Diskette Drive and CD-ROM Drive



CAUTION: Observe the precautions in "Safety First—For You and Your System" in Chapter 7 and the safety instructions in the *System Information* document that came with your system.

To remove the 3.5-inch diskette drive or the CD-ROM drive, perform the following steps:

1. Remove the cover.
2. Remove the power cables from both the 3.5-inch diskette drive and the CD-ROM drive.
3. Remove the interface cable from the back of the 3.5-inch diskette drive.
4. Remove the three screws securing the 3.5-inch diskette drive bracket and the CD-ROM drive bracket to the floor of the chassis.
5. Lift the 3.5-inch diskette drive and bracket out of the chassis and set it on a smooth, nonconducting work surface (see Figure 9-4).

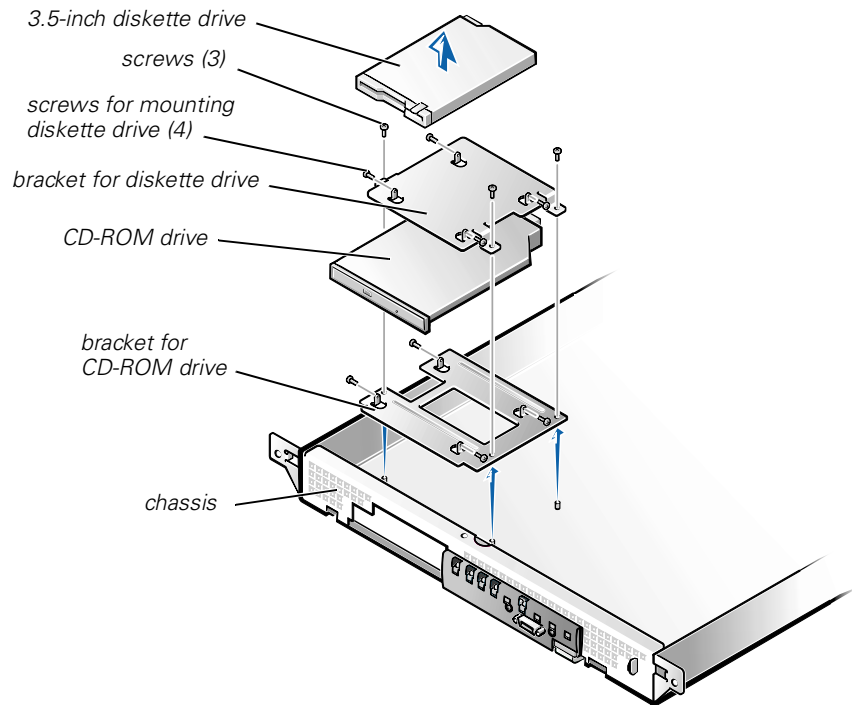

Figure 9-4. Diskette Drive and CD-ROM Drive Removal

6. If you are also removing the CD-ROM drive, remove the IDE cable from the back of the CD-ROM drive.
7. If you are also removing the CD-ROM drive, lift the CD-ROM drive and its bracket out of the chassis.
8. Remove the faulty drive (either the 3.5-inch diskette drive or the CD-ROM drive) from its mounting bracket by removing four screws (see Figure 9-4).

To install these drives, reverse the order of the steps.