

Dell™ Systems

Removing the Lock Catch From a 42-U Rack Cabinet



Notes, Notices, and Cautions



NOTE: A NOTE indicates important information that helps you make better use of your computer.



NOTICE: A NOTICE indicates either potential damage to hardware or loss of data and tells you how to avoid the problem.



CAUTION: A CAUTION indicates a potential for property damage, personal injury, or death.

Information in this document is subject to change without notice.

© 2002 Dell Computer Corporation. All rights reserved.

Reproduction in any manner whatsoever without the written permission of Dell Computer Corporation is strictly forbidden.

Trademarks used in this text: *Dell* and the *DELL* logo are trademarks of Dell Computer Corporation.

Other trademarks and trade names may be used in this document to refer to either the entities claiming the marks and names or their products. Dell Computer Corporation disclaims any proprietary interest in trademarks and trade names other than its own.

June 2002 P/N 8T573 Rev. A01

When installing a new front door on a 42-U rack cabinet that has a lock catch on both horizontal frame members, you must remove the lock catch on the hinge side of the rack cabinet before installing the new door.

NOTICE: An installed lock catch on the hinge-side of the rack will damage the new door if you do not remove the latch before installing the door.

To remove the lock catch from the hinge side of the rack cabinet, perform the following steps.

CAUTION: See the *Rack Installation Guide* that came with your rack for complete safety instructions before beginning this procedure.

- 1 Use a #1 Phillips screwdriver to remove the two #1 Phillips screws that hold the lock catch to the middle horizontal frame member.

NOTE: A Torx screw is on the horizontal frame member under the lock catch. Do not remove this Torx screw.

- 2 Remove the lock catch (see Figure 1-1).

Figure 1-1. Removing the Lock Catch

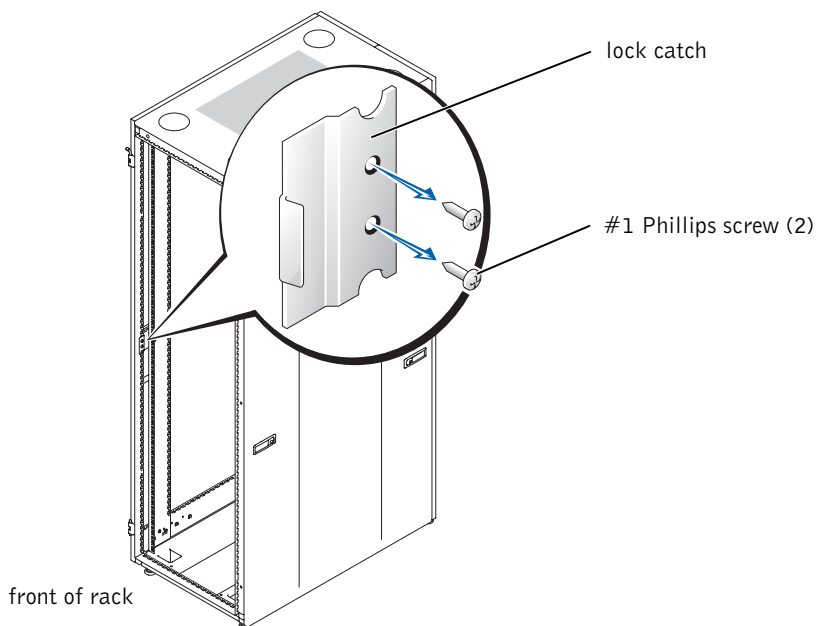

- 3 On the horizontal frame member that held the lock catch, reinstall the two #1 Phillips screws to maintain structural integrity.